

Divine Lorraine Hotel and Land Development Proposal

U3 Advisors



Vacant parcel adjacent to the once-grand Divine Lorraine

The impressive historic Divine Lorraine Hotel sits majestically at the intersection of Broad Street with Fairmount and Ridge Avenues, but it had been vacant, neglected, and vandalized for many decades. This phased development study explores student university housing on the adjacent parcel to the east of the building along with restorative and modernizing renovations to the existing hotel building. The final mixed-use build out proposes over 800 residential units and nearly 100,000 sf of commercial spaces with underground parking. The new community is centered around a courtyard that is engaged by commercial and social spaces on the ground floors with varying heights of residential buildings above.

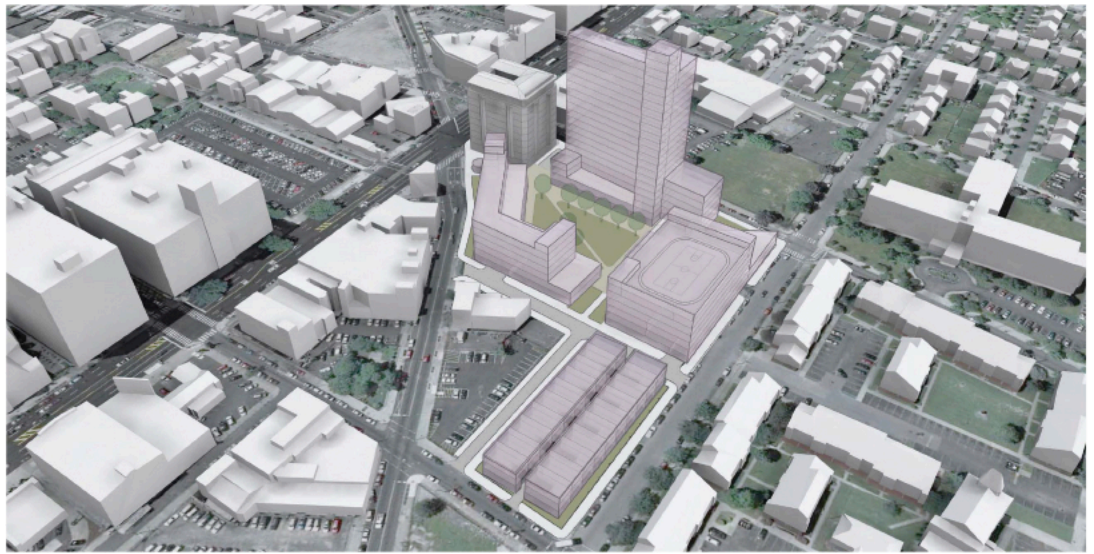

Phase 2

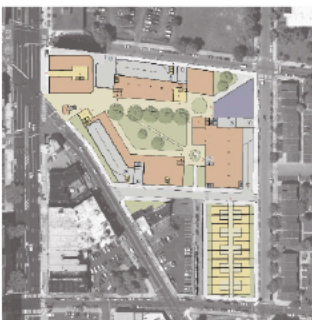

Phase 4

